



PRECISION BALANCE

BAL25-0210



INDEX

1. Model specification and index	2
2. Structure Diagram	3
3. Display Icon	5
4. Working Condition	6
5. Operation Requirements	6
6. Operation	7
7. Calibration	7
8. Weighing	8
9. Tare	8
10. The counting operation of balance	9
11. Cautions	9
12. Unit Change	10
13. Weighing Range Setting	10
14. Minimum weight setting	11
15. Package list	11

BAL25-0210 Precision Electronic Balance is a kind of intellectual measuring instrument with weighing, counting and other many functions. The product introduces imported integrated circuit and enjoys stable and reliable performance, easy operation and accurate weighing and counting, as a kind of measuring instrument.

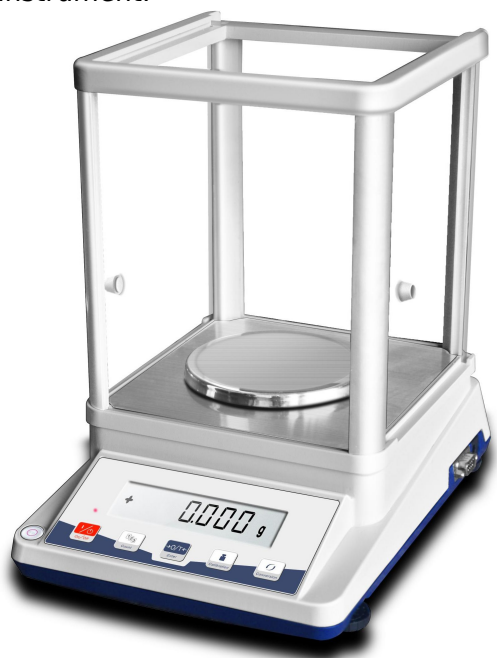

Figure 1

1. Model specification and index

Model	Capacity	Readability	Size Of Weighing Pan
BAL25-0210	210g/1mg	1mg	Φ90mm

Table 1

2. Structure Diagram

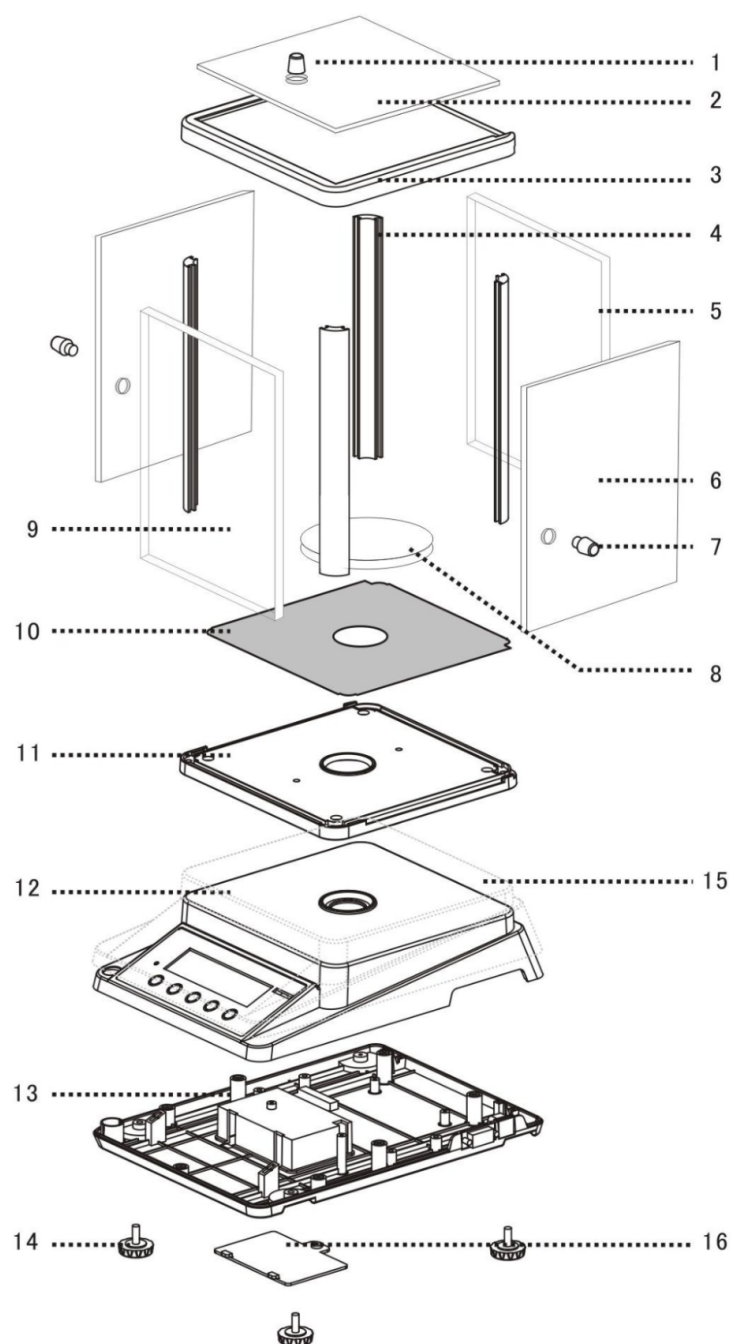

- | | |
|----------------|------------------|
| 1 Top Handle | 9 Front Glass |
| 2 Top Glass | 10 Under Tray |
| 3 Shell 01 | 11 Shell 02 |
| 4 Vertical Rod | 12 Shell 03 |
| 5 Back Glass | 13 Shell 04 |
| 6 Right Glass | 14 Adjust Feet |
| 7 Right Handle | 15 Dust Cover |
| 8 Weighing Pan | 16 Battery Cover |

Figure 2

3. Display Icon

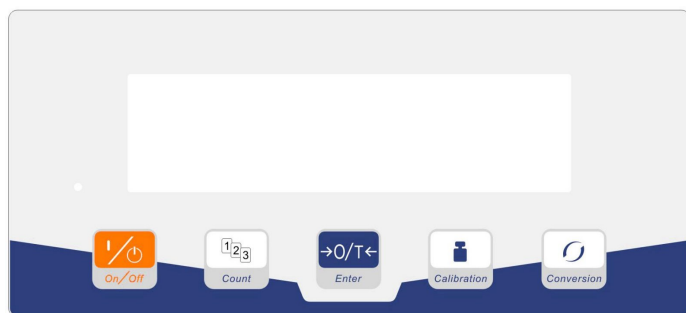

Figure 3

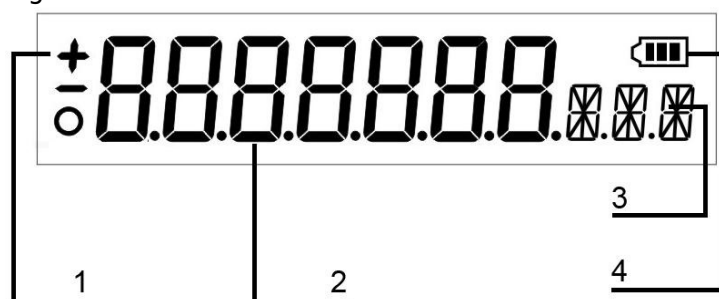

Figure 4

1. Status icon: "+" and "-" is the reading state, the "O" means the weighing process, when it disappears, the weighing is stable.
2. The digits: the digits mean the object weight
3. The unit icon
4. The residual capacity of the battery

4. Working Condition

Working Temperature: 0°~50°C,

Maximum Consumed Power: 5W

Temperature Fluctuation: 5°C/h,

Power Supply: 100-240V 50-60HZ

Comparative Humidity: 50 % ~ 85 %

5. Operation Requirements

When it is operated, electronic balance shall be placed on stable working platform to avoid the influences from mechanical vibration, direct sunshine and air current etc.

6. Operation

Power- on :Press the “ON/OFF” key, and the display indicates in turn “8.8.8.8.8.8.”, “-”, “-”, “-”, “-”, “-”. At last it shall display the weighing “X.XXX”. If any error founded in display, you may turn on and turn off the balance once more. Then it will be operated normally.

7. Calibration

(1) Calibration Requirements

When distinct errors appeared in the weighing of balance, the balance shall be recalibrated to make weighing accurate. The recalibrated balance shall be placed on the stable working platform without the influences from the vibration of air current and strong electromagnetic wave. The calibration results will be more accurate after turn on the scale and warm up for more than 20 minutes .

(2) Calibration Procedure

Turn on the balance it shall display the weighing mode as “0.000”, then press the “CAL” button until shows “CAL”, then release. Display blinkingly the standard weight value and then place same value standard weight; The “= = = = =” will be displayed; then display stably weight value and remove weight. then “= = = = =” will be displayed. the “0.000” will be displayed. The calibration is finished.

8. Weighing

(1) Turn on the balance to make it warm up stably and display “0.000”.

(2) Place a thing on the weighing tray and display the weight of the thing. It indicates the weight is already stable when the display value is not changed again.

9. Tare

- (1) If there is a container on the weighing tray, the balance displays the weight of container.
- (2) Press " " and then "0.000" will be displayed. It indicates that the tare has been deducted.
- (3) Place the thing into container and the balance will display the weight of thing.

10. The counting operation of balance

Press "COU" button and "COU" will be displayed. Then display blinkingly one of value of counting mode, "5,10,20, 40, 50, 100, 200, 300, 400, 500" Press "" and choose one mode value. Place the things with same quantity with mode value on the weighing tray and then press "COU" . Then "= = = = =" will be displayed. Very soonly , it will display stable mode value and then the setting of counting operation is finished. After that, counting operation could be conducted. Place the things in the weighing tray and display will show the quantity of thing.

(1) Counting operation requires the weight of weighed thing must heavier than the four times of minimum reading value, or the difference of counting could be great if not counting can't be done.

(2) Quit the counting operation:

Press the "COU" button and then "= = = = =" will be displayed. The balance may quit counting operation state immediately and return the weighing state.

(3) Overload warning

When weighing thing is over the maximum weighing value of the balance, the display will show " " and indicate the thing is overloaded. The weighing thing shall be removed to avoid damaging the balance.

11. Cautions

- (1) Please turn on and warm up the balance according the requirements before you weighing the things.
- (2) Working environment and conditions shall conform to the environment requirements.
- (3) The weight of all weighing things on the weighing tray can't exceed the required weighing range.
- (4) When weighing is not accurate, calibration shall be undertaken by use of standard weight according to concerning requirements.
- (5) If user found any defection in the balance, don't try to disassemble the machine shell and repair it to avoid damaging the precision parts in the machine. Please take it to the distributor or send it to the manufacturer and let them repair.

12. Unit Change

There are three units can be choose,press "UNIT" and choose the unit you need : gram , ct ,oz.

13. Weighing Range Setting

There are two weighing range can be choose, Press ""+"UNIT"to change the"0.00" and"0.000".

1.When the display show"0.000" the max weight is 100g,if the weight more than 100g, the accurate will be change to "0.00"automatic.

Note: In order to protect the sensor and the procedure, if you need 0.01g precision, please replace the 0.01g readability

2.When the display show"0.00",the max weight is 600g , and the total capacity is"0.00" accurate.

14. Minimum weight setting

Under the weighing range you need, you can choose the minimum weight as your requirement ,for example ,we choose the "0.00" accurate ,so we can set the minimum as following:

1. Turn on the balance when it display"0.00"
2. Press" →0/T← "+"COU",when it will display "1d"(there are 1d to 5d five digits can choose)
3. Press "COU" or " CAL " to choose the minimum weighing you required. then press" →0/T← "to confirm your choice.
4. If you need choose "0.000"minimum weighing ,please choose the "0.000"accurate first.

15. Package list

Electronic Balance	1	Instruction Book	1
Weighing Tray	1	Power Adapter	1
Standard Mass	1		

LABSTAC

Labstac LLC

82 Wendell Avenue, STE 100, Pittsfield, MA, 01201, USA

Email: contact@labstac.com | Website: labstac.com